

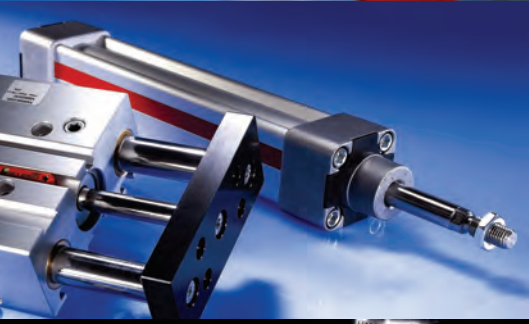

# Intelligent Automation

Т U V Q P A Á Ú ß ^ ~ { æ æ Å å Æ Ö Æ Ö Æ Å • ç }

simply the first



Rodless Cylinders  
@bYUf; i JXys  
9YWFJW5Vh Uhcfs  
A chcfğžGearheads  
Air Cylinders  
DbYi a UhjWJ Uj Yg  
: F@žFittingsžHi VY  
Vacuum Equipment



# The complete world of modern compressed air management

Modern automation technology would not be possible without efficient compressed air treatment. With the comprehensive **airfit** series HOERBIGER-ORIGA is an established leader for compressed air management systems.



**airfit** covers all requirements between G1/8 and G2. All market requirements are available including standard components, special solutions and fully integrated compressed air management systems.

**airfit** components are completely modular, enabling highly specialised system solutions for specific applications to be produced, even in the smallest of quantities.

- Stop valves
- Pressure control valves
- Filter water separators
- Oil mist lubricators
- Start/stop valves
- Microfilters
- Activated carbon filters
- Central lubricators
- Injection lubricators
- Prop. pressure regulators
- Comprehensive accessories ... in all connection sizes and with many options



**airfit** control electric regulators



**airfit also available as ATEX version**

- with special functions
- with special pressure ranges (up to 45 bar and more)
- with special temperature ranges (-40 to +120° C)
- for special media e.g. oxygen, nitrogen, etc.



**Membrane dryer**  
**airfit dry**

The innovative membrane technology and especially the patented purge air control makes the membrane dryer **airfit dry**, one of the leading devices of its kind. As an ideal end-of-line solution, it is particularly suited for highly sensitive areas like medical technology, electronics, as well as

mobile pneumatic applications and industrial automation. Exceptional performance is guaranteed, even in the most arduous environmental conditions

- No electrical connection
- No additional sensors or control elements
- No wear and tear due to the absence of mechanically moving parts
- Practically silent
- No alteration of the air composition
- Flexible depending on drying purpose
- Fast response
- Up to 16 bar

**airfit light** G1/8, G1/4  
small, lightweight,  
with an intelligent interior



**airfit swing** G1/8, G1/4, G3/8  
the technically and economically  
convincing solution



**airfit A15** G1/2, G3/4  
- for highest operating comfort  
- with many individual components



**airfit A25** G1 (G3/4)  
a full one inch unit for the  
harshest environments



**airfit airfit A50** G2 (G11/2)  
Main line devices for pressurised  
lifting gear in the offshore region,  
blow moulding machines, etc.



**Microfilter MF** - filtration efficiency 99.999%. **Active carbon filter MC** - residual oil content 0.003 ppm



Special devices upon customer request:  
valve maintenance combination unit

# airfit A50

G1.1/2, G2"

Type: A50F-ADV

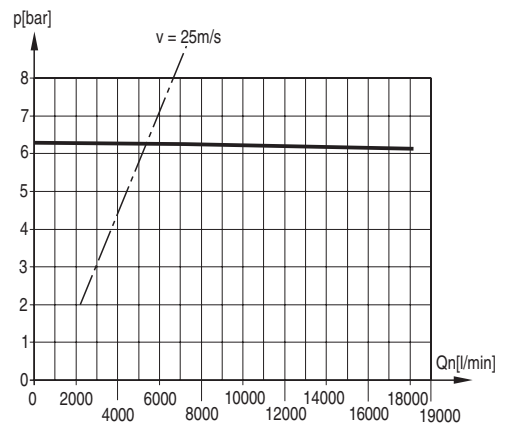
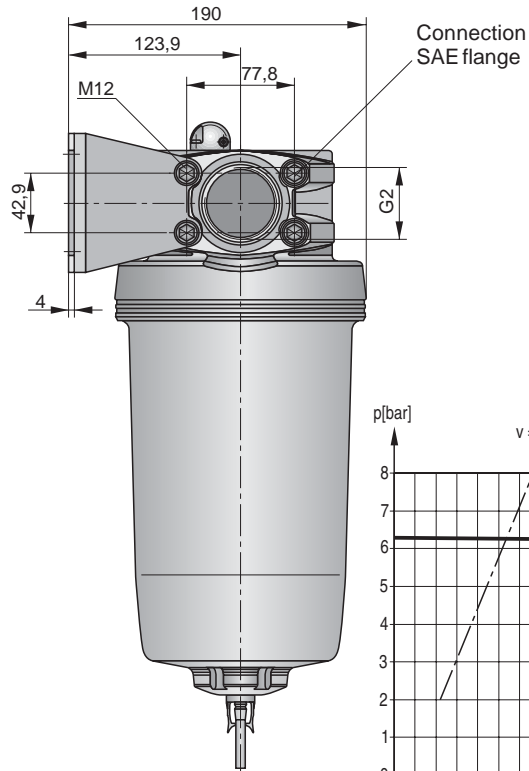
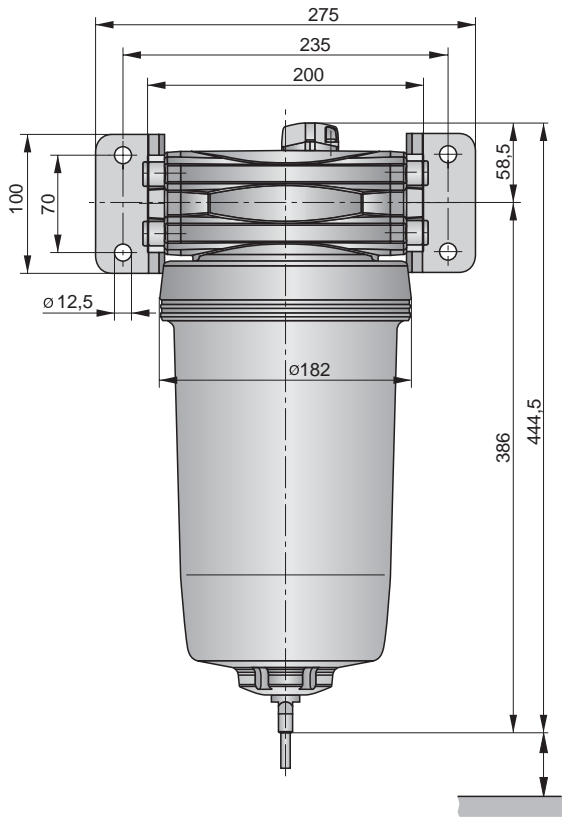

Type: A50R, A50RV

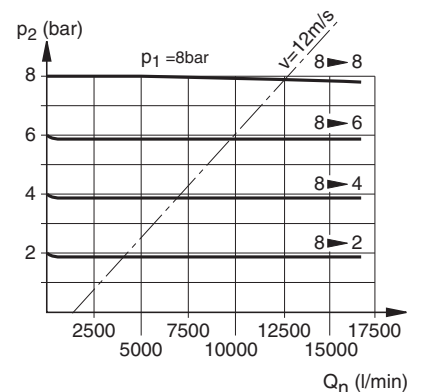
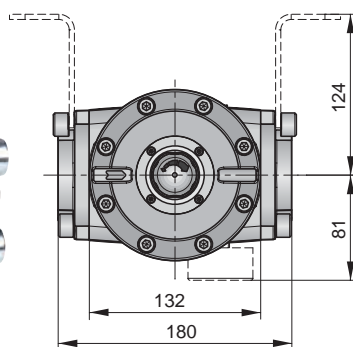
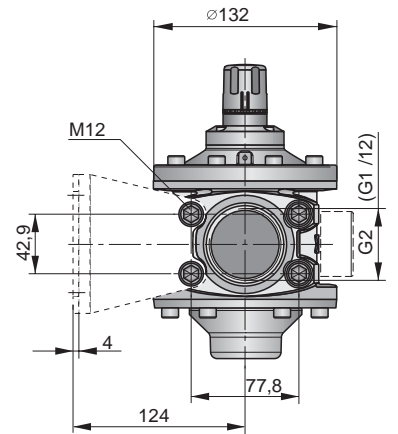
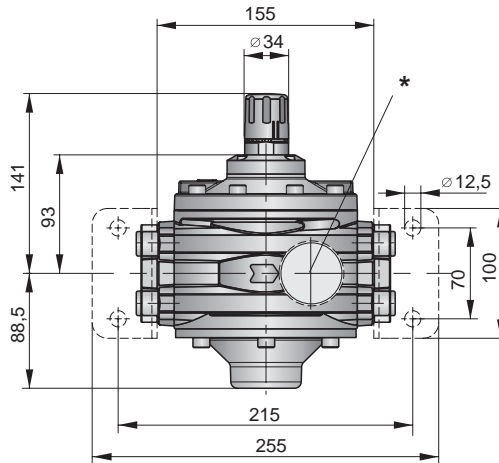

... and a comprehensive range of accessories  
 – in all sizes and with many options



Float-type AutoDrain



TimerDrain, Strainer, Ball Valve



Air Tank

Characteristics Common to All airfit A50 Units

Filter-Water-Separator		A50F-1 1/2	A50F-2
Weight (mass)	kg	5.50	5.25
<b>Pressure Regulator</b>			
Weight (mass)		3.5	3.5
Port sizes		1 1/2	2
Maximum flow rate	Q	>40000	>40000
	l/min	>2400	>2400
	m <sup>3</sup> /h		
Operating pressure range, inlet	p <sub>1 min</sub>	0	0
	p <sub>1 max</sub>	17.5	17.5
Operating pressure range, outlet	p <sub>2 min</sub>	0	0
	p <sub>2 max</sub>	8(16)	8(16)
<b>Micromist Lubricator</b>			
Port sizes		1	2
Weight (mass)		10	18
Recommended flow rate	Q <sub>min</sub>	100	200
	Q <sub>max</sub>	5500	17000
Operating pressure range	p <sub>max</sub>	10	10

Type: DV-1/2i automatic drain



airfit A04R 4 and 6 mm pressure regulator for panel mounting



- minimum size
- high flow rates
- push-in connections
- DIN rail mounting

Injection Lubricator Combination G1/4-G1  
 Version with airflow sensor

Flow Characteristics: Type LUBI-08

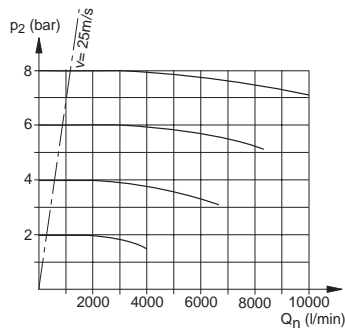

Port size		G1/4	G3/8	G1/2	G3/4	G1
Weight (mass)	kg	0.65	0.65	0.65	0.75	0.80
Operating pressure range	p <sub>min</sub>	3	3	3	3	3
	p <sub>max</sub>	16	16	16	16	16
Recommended flow rate	Q <sub>n</sub>	550	850	1900	3500	5000
	l/min					
	m <sup>3</sup> /h	33	51	114	210	300

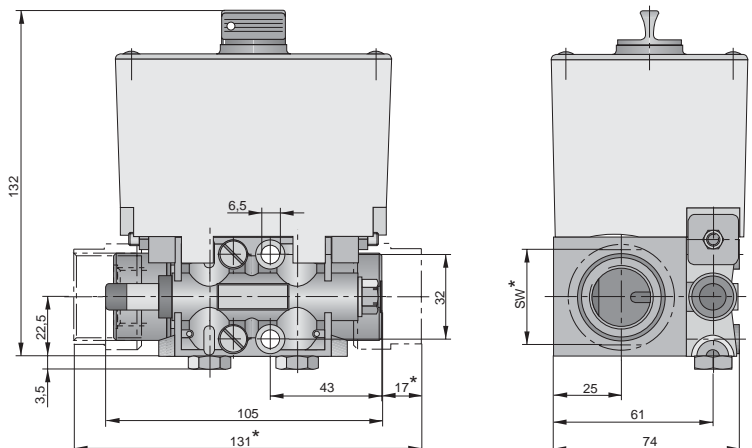

\* only for LUBI-20 SW = 36  
 LUBI-25 SW = 41

# Air preparation units

Series airfit A50  
G1 1/2, G2  
– with/without thread flanges

## Dimensions

### Delivery includes:

- Basic version (without thread flanges)  
1 product
- Version with thread flanges  
1 product  
2 thread flanges

Filter-water-separator – Type: A50F-11/2, -2  
Dust filter – Type: A50FD-11/2, -2

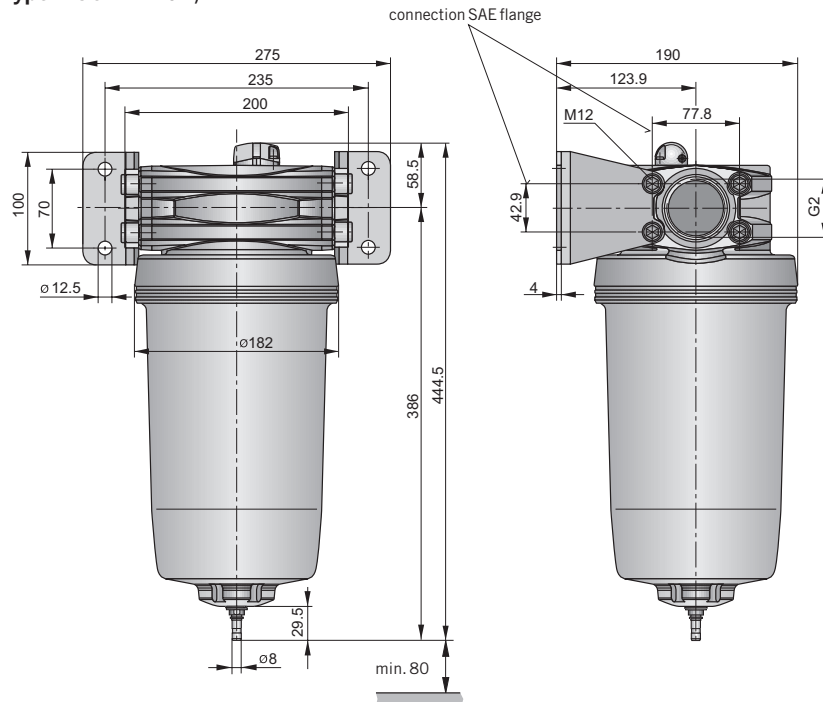

Pressure regulating valve, pilot operated with integrated pilot pressure regulating valve  
Type: A50R-11/2, -2

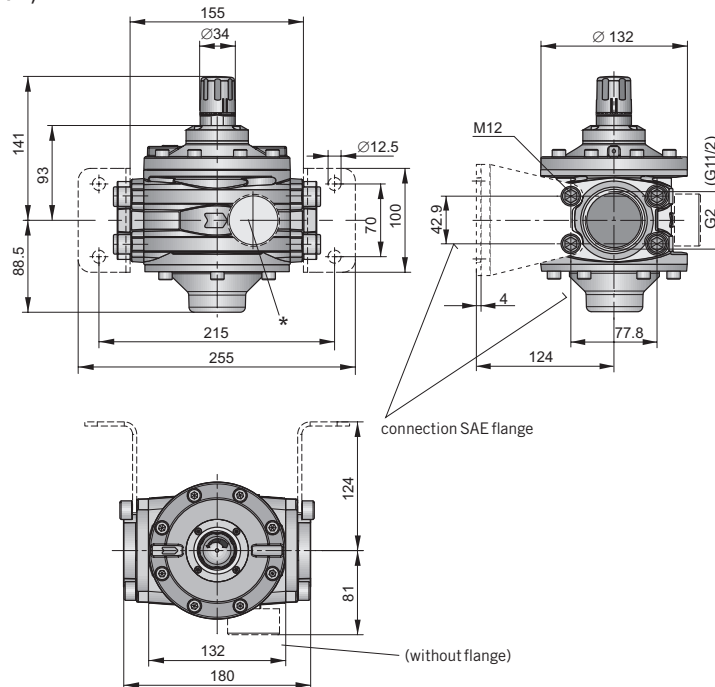

On delivery the plug screw is not assembled.  
\* Two opposite gauge ports G1/4

Dimensions in mm

**Pressure regulating valve, pilot operated – Type: A50RV-11/2, -2**

– Recommended pilot regulating valve, series airfit swing, Type: SR-1/4, PB45449-058

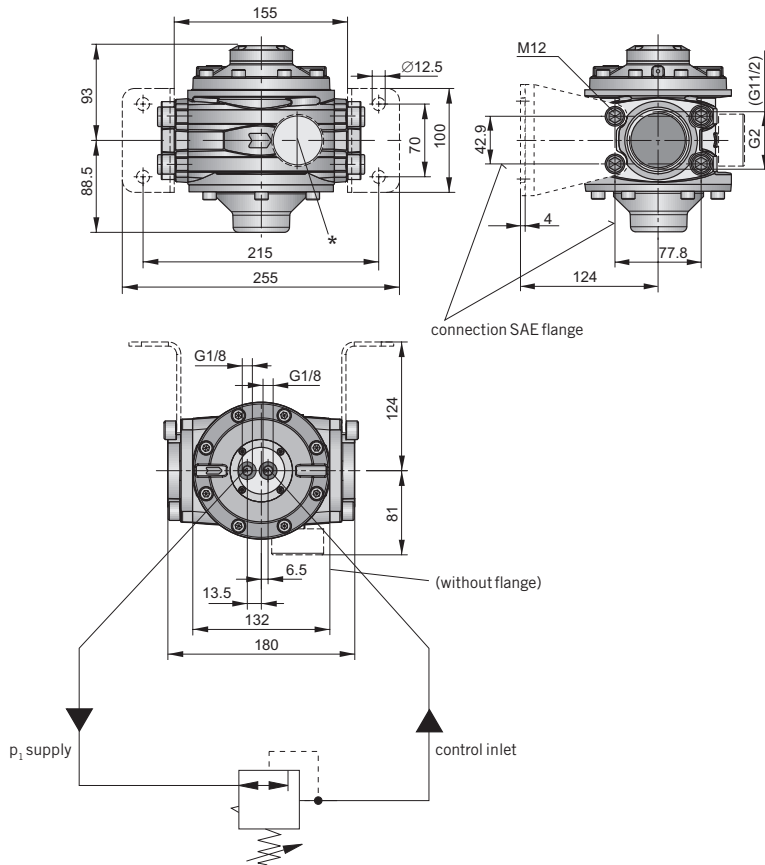

**Air preparation units**

*Series airfit A50  
G11/2, G2  
– with/without thread  
flanges*

*Dimensions*



On delivery the plug screw is not assembled.  
\* Two opposite gauge ports G1/4

Dimensions in mm

